

# The Crossing Gate

Spring  
2008

Vol. 27, No. 1



Newsletter of the Twin Cities Division, Thousand Lakes Region, National Model Railroad Association • [www.tcdnmra.org](http://www.tcdnmra.org)

## Membership Issue: Board Calls for Full Discussion at Annual Business Meeting

The lead story in the last issue of the Crossing Gate dealing with the NMRA regulations that require NMRA membership in order to attain membership in a region or in a division has raised a host of questions for the Twin Cities Division's Board of Directors. This subject has resulted in frequent discussions for the TCD Board of Directors, has caused the Board to seek consultation from the Thousand Lakes Region and from the NMRA itself. **The Board now seeks the input of both TCD members** (those belonging to the NMRA and residing in the TCD service area) **and from subscribers** (those subscribing to the Crossing Gate but who are not NMRA members) at the Annual Business Meeting to be held on **May 8, 2008 at the Jackson Street Roundhouse** (193 Pennsylvania Avenue East, St. Paul, MN 55130).

For most of the 26 years of the TCD's existence, the majority of its participants could not be classified as "members" under the current NMRA regulations. That continues to be the case. As of March 2008, the majority of TCD subscribers (58) are not NMRA members compared to a minority (32) subscribers who are NMRA members. That statistic coupled with the fact that NMRA affiliation comes without any form of funding except for in-kind benefits such as liability insurance, has caused the TCD Board of Directors to request that all stakeholders (members and subscribers) attend the May 8th Annual Business Meeting to discuss the future of the TCD. The discussion is to give the Board of Directors direction as to how to proceed. The intent of the meeting is purely for discussion...no decision will be made at the meeting. But, the Board needs to have a course of action to follow, and the discussion should provide the framework for that course of action.

All options will be on the table. The TCD Board is looking at the larger picture. All options that best serve those who affiliate with the TCD at any level will be considered. The options could range from reincorporation as an organization without affiliation to the NMRA, to continued NMRA affiliation with strict enforcement of NMRA regulations, to the complete dissolution of the TCD.

Come prepared to support whatever organizational structure that you believe to be in the best interest of the people who participate in Twin Cities Division activities, be they members or subscribers, and you will be heard. The Board wants to hear all arguments.

Because at least one bylaw change (elimination of the Contest Director as a board level position, see the Winter 2007-8 Crossing Gate) is to be a part of the Annual Business Meeting, and because the current bylaws allow only members to be able to vote on bylaws changes, be sure to bring verification of current NMRA membership if you are an NMRA member.

If you have questions or are unable to attend, contact any Board member via the web site email at [www.tcdnmra.org](http://www.tcdnmra.org) or call Ron Bodin, Superintendent at (763) 755-8408.

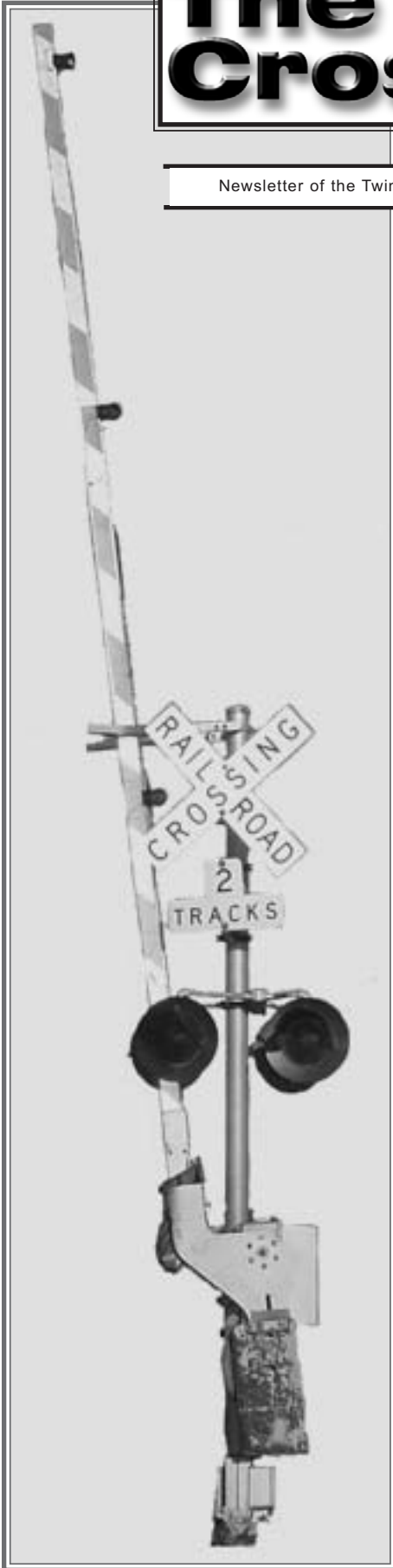

## Twin Cities Division

### Board of Directors

For all Division business or questions:

**Superintendent**

Ron Bodin  
super@tcdnmra.org

To volunteer to give a clinic:

**Assistant Superintendent**

Cal Swenson  
asuper@tcdnmra.org

To volunteer for a train show or "Timetable" entries:

**Chief Clerk**

Dave Hohle  
clerk@tcdnmra.org

For membership problems, CROSSING GATE subscription or address problems, or website issues:

**Paymaster**

Eric Boone  
tcdpaymaster@peremarquette.net

For article or photo submissions:

**CROSSING GATE Editor**

Dennis Rogers  
763-780-4976  
editor@tcdnmra.org

For hobby shop or door prize questions:

**Public Relations**

Don Smith  
pr@tcdnmra.org

**Director at Large**

Bruce Notman  
assistant@tcdnmra.org

**NMRA Contest Chairman**

position open

### Chairpersons

For Golden Spike or NMRA Certificate questions:

**NMRA Achievement Program**

Dave Hamilton  
763-449-0058  
ap@tcdnmra.org

To volunteer your layout for a tour, or suggest one:

**Layout Tour Chairperson**

Arthur Hill  
tours@tcdnmra.org

**Education Chairperson**

Bruce Selb  
ed@tcdnmra.org

**Popular Vote Contest Chairperson**

Pam Notman

**VOLUME 27, NUMBER 1, SPRING 2008**

THE CROSSING GATE is published quarterly by the Twin Cities Division of the Thousand Lakes Region of the National Model Railroad Association. Material may be reprinted with permission.

Articles, photos, tips, or ideas are heartily encouraged and will be enthusiastically accepted in any format (PC or Mac; Word, Simple Text, typed, handwritten, scribbled on the back of a bar napkin, etc.). Send it to your editor by regular mail to THE CROSSING GATE, 9677 Able Street NE, Blaine, MN 55434, by email to editor@tcdnmra.org.

Be part of the Division! If you're an NMRA member, become a Regular member of the Division (you get a year's subscription to THE CROSSING GATE, plus voting privileges) for only \$10 per year. If you're not an NMRA member, become a Subscriber (you get a year's subscription to THE CROSSING GATE) for only \$10 per year.



## From the Superintendent

**C**hanges, changes, changes. What would life be without them?

**A new meeting place:** beginning in October 2008 we will hold our monthly clinics in the Jackson Street Roundhouse (193 Pennsylvania Avenue East, St. Paul, MN 55130).

**A new time:** also starting in October 2008, the times for the clinics will be returned to 7:00 pm.

We will get away from paying for parking, and we will be meeting in a real road atmosphere. Please join us when we switch to the new location in October 2008. And, tell us what do you think of the new location. There will be more details as we approach October.

Other changes are to be found in this issue of the Crossing Gate.

We lost a great asset to Twin Cities model railroading last month when N-Shop owner, Dick Aronson passed away. I spent a lot of money at Dick's shop. In fact, I used to keep a bag in back of the counter, and like

Norm on Cheers, I had a tab that never seemed to be paid-up. Dick was a generous man who contributed items for door prizes at our clinics for many years. It is that kind of relationship with the hobby shop owners that cannot be attained with dot com hobby stores which is another reason why I ask you (as I always do) to support our local hobby stores

Your Superintendent,  
Ron Bodin

**Contributors to this issue:**  
*Jim Bernier, Ron Bodin, Lester Breuer, Arthur Hill, David Hohle, Fred Holzapfel, Don Smith, and Walter Thompson.*  
**THANKS!**  
**Deadline for next issue:**  
*July 15, 2008*



## From the Editor

**A**s this is my last issue as your editor, I would like to thank all those who contributed articles, photos, and other data over the past few years. This has certainly been an exciting time to be a member of the TCD Board of Directors, too. With the changes in venue and the current controversy over membership, there has been a lot of action.

Some of you may have heard that I had offered to stay on as editor if I got help. A couple of people stepped up to the plate to give me that help which I greatly appreciated, but some other things have led me to decide that even with the help, it is time to step aside.

As of this writing, no one has come forward to assume the editor position. It continues to be my hope that someone will come forward soon, so that I can help them to get the next issue ready for publication in August. It is a highly rewarding (and sometimes challenging) role, but being the editor for the TCD is a great way to meet fellow modelers and to get charged with enthusiasm for model railroading.

Thanks for allowing me to be your editor.

Dennis Rogers



# IN MEMORY OF JIM B. PERSKE

by  
**Lester Breuer  
and  
Fred Holzapfel**

Jim Perske, National Model Railroad Association life member, Thousand Lakes Region member and founding member of the Twin Cities Division died peacefully at home on January 30, 2008 surrounded by his loving family. At 78 years of age Jim led a full life with a love of model trains that started in his youth while railfanning with his father. During his youth he accompanied his father while filming movies of the colorful and varied railroads throughout Wisconsin and Minnesota. In his attic they would set up and run a wide variety of early tinplate trains. Eventually Jim married Audrey, and moved East in his occupation as a safety engineer working for the Saint Paul companies. He was a member of the Washington DC model railroad club and made time to railfan when driving between inspections. Jim grew to love the Clinchfield Railroad and an obscure little narrow gauge called the East Tennessee and North Carolina RWY (The Tweetsie).



After returning to the Twin Cities Jim would frequent Woodcraft Hobby shop on Lake Street to purchase equipment for his railroad named "The Clinchfield and Ohio." There he met Doug Hodgdon who invited

him to join in regular operating sessions on Friday nights at Doug's home. For Jim this was just a starting point. Jim's passion for model railroading and love of people drove him to become involved in many different railroad groups throughout his

life. Among groups not already mentioned: G-Whiz Gang, Tuesday Night Roundhouse, Minneapolis Society of Model Engineers, Twin City Model Railroad Museum, and various historical societies.

Jim was not a person who joined a group just to be a member; he was active, he was a "doer." At conventions and train shows he was always helping promote the hobby. At monthly get togethers at the Countryside Restaurant, later TCD monthly clinics, he frequently assisted with the model railroad clinics. In the 1970's and 1980's we were fortunate to have annual model train shows at Har Mar Mall and Northtown. At the shows Jim became a frequent displayer which led to his being invited to display his modeling at the 1977 MRIA show.

In 1981 the Model Railroad Industry Association, MRIA, began plans to return to the Twin Cities with their annual industry show and meetings. Jim was one of the original committee members who helped plan and make the 1982 MRIA show a success.

In May 1982 the Twin Cities Division

**Continued on page 5  
Jim Perske**

## *Our Industry is Changing*

by *Don Smith*

There are some changes coming to the model railroad manufacturing industry as a result of a US Supreme Court decision (Leegin Creative Leather Products vs. PSKS) which came down last year. Basically what the high court decision says is that a manufacturer can demand that any internet retailer must not show a discounted price for its product if the manufacturer so desires retail price only.

Also a brick and mortar retailer (non-internet) also cannot offer to sell that manufacturer's product at a discounted price in any advertisement in a newspaper, poster, radio or television advertisement. If any retailer does advertise or

offer for sale a manufacturer's product, and has been so directed by that manufacturer not to do so, then the manufacturer can terminate that retailer's ability to buy product from the manufacturer without further notice.

Now then, here is the scoop as to what has happened:

1. Internet retailers have gotten very clever and added buttons next to the retail price that say "Press this button and get your discounted price" or they have a discount schedule based on the value of the item or the total value of the order. These methods may result in that retailer's loss of ability to purchase that product

from the manufacturer and loss of warranty repair service.

2. Internet retailers may have added a note to call the retailer to negotiate a price. In doing so, that retailer is behaving responsibly and can retain status as a full dealer.

3. An internet retailer who has a "username & password" protected site can operate within the spirit of the law and offer "discriminative" pricing to an individual customer.

4. A "brick and mortar retailer" may have posted a sign in the window of its store offering a product (from that manufacturer) at a discounted price. That retailer can lose its ability to order from that manufacturer.

**Continued on page 5  
*Industry***



# Modeling Tips & Tricks

## Automatic wheel cleaner, well almost...

By **Walter Thompson**

Cleaning wheels with a cotton swab, E-Xato blade, or any other device that requires removing the model from the layout creates other problems—finger prints on the model, changing of axle/wheel alignment, and breaking of delicate parts on the model are problems I ran into. Often the wheels were not totally cleaned of gunk that had collected, and rough spots were left on the wheels.

The Center Line track cleaner rolls Handi Wipe material over the tracks to clean them and works quite well when used with Acetone (finger nail polish remover, less the perfume). So why wouldn't rolling the wheels over the Handi Wipe clean the wheels?

I stretched a 1" wide piece of Handi Wipe over a piece of track (HO) and

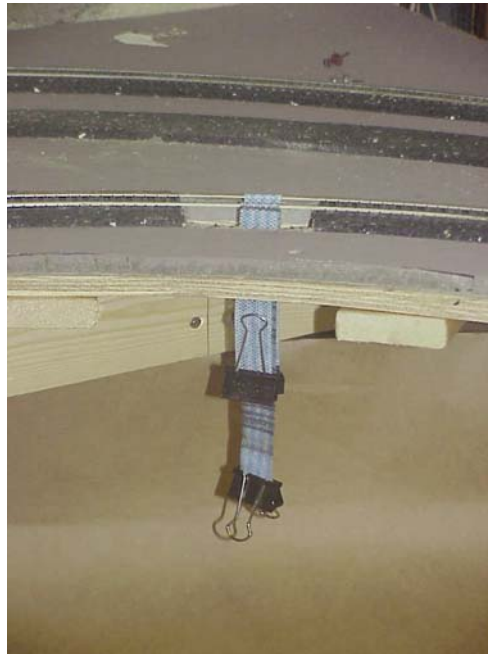

This is a photo of the completed automatic wheel cleaner on my layout.

with the five-finger helper moved a box car back and forth. Lots of gunk on the Handi Wipe, but the horn for the Kadee coupler liked to snag in the center on the Handi Wipe. I then cut about an 2" square area out of my road bed in the shop area of my layout (out of normal view) and after removing the ties, hung a piece of Handi Wipe over both rails. The ends of the Handi Wipe pieces were weighted with three paper clip binders— one clip in the middle attached to both strips, and two more clips weighing down the other ends of the strips.

Presto, as a train rolls over the cleaning section the wheels are automatically cleaned! Just wet the Handi Wipe with Acetone from an old oil applicator. But even if the Handi wipe is dry it will wipe the wheels and help keep them clean As an area gets grimy, just move the strips to a clean area.

## Almost Free Modeling Tools

By **Lester J. Breuer, MMR**

With the snow and cold weather and the holidays behind us, if you are like me you tend to spend more time at the modeling bench. I still spend time a good deal of time there because the majority of the models I purchase still need assembly. To assemble models the basic tool is glue of some type with Cyanoacrylate or CA I am guessing having the greatest use.

CA comes in a container of some type. Normally CA applied to a model out of the container makes for a messy looking glue joint. Of course, we do not want that. A neat looking glue joint is usually obtained by applying a small amount of glue to the glue joint with an applicator of some type. The normal applicator being a wire dipped into the CA. A better applicator, in my opinion, is a needle with

half the eye removed and inserted into a handle for easy use. Yet no matter what the choice of applicator, it must inserted into the CA to apply it to the model glue joint. So we need another container.



In past modeling years I have tried several containers to hold the CA and finally I have found one, a bottle cap, I think is the

easiest to use. Since I drink several bottles of bottled water every day obtaining bottle caps is no problem. So rather than throw the bottle caps in the trash I collect and recycle them for CA container use.

When I use CA I put only three or four drops in the bottle cap. If the bottle cap is left flat the CA is hard to get out of the bottle cap so I prefer the bottle cap be on a slant so the drops collect in the bottom of slanted cap for easy access. To get the slant on the bottle cap it needs a holder. I use a piece of foam with a circle, the size of the bottle cap, cut out for holding it in a slanted position. You can see my holder design in the enclosed photo.

When you look at the photo you see the bottle cap holder has two bottle caps

Continued on page 5  
[Almost Free Modeling Tools](#)

Continued on page 5

### Industry

5. If a brick and mortar retailer discounts the price for a product to an individual customer, that retailer would be operating within the spirit of the law.

6. Retailers displaying that manufacturer's products at a train show, swap meet or other such event can discount their price with immunity.

This may sound very heavy handed on the part of the manufacturer and some

Continued from page 4

### Almost Free Modeling Tools

rather than one. Why? Well the second bottle cap holds several drops of Zip Kicker. If you are not familiar with Zip Kicker it is an accelerator for CA. A touch of CA with an applicator followed by a touch of Zip Kicker with another applicator provides an instant set glue joint.

Once in a while if you use the two bottle cap system, you as I may put the wrong applicator in the incorrect bottle cap resulting in you becoming a "unhappy modeler" and a ruined bottle cap. The

may claim that this is a "restraint of trade" but it is not according to the Supreme Court ruling. Any manufacturer has the right to maintain the integrity of its products in the marketplace. It may have a copyright on its product to protect it, it may have a huge expense in product development and intellectual property, and it should have the right to prevent its product from being marketed in such a manner as to allow it to cheapen the value of the product or become a commodity.

This court decision has another side to it in that it will also help the "brick and mor-

tar" retailers compete against internet mass marketers, thus in general, protecting the industry. The bottom line is this: If you purchase a product from a business publicly offering discounted prices, you may not be guaranteed a warranty or factory service. You may be buying from a non-licensed retailer. This is not a "might" happen scenario...it has already begun. Kato USA instituted a retail price floor on Feb 13, 2008. Most others major manufacturers have plans to follow suit within the next few months.

bright side, you throw the bottle cap in the trash and replace it with another one. Even if you never make this mistake the CA will build up in the bottle cap that will require you to replace it. Again the bright side, you throw the bottle cap away and replace it with another one with no major time loss. Note, I said throw the bottle cap away so no cleaning of the CA container is necessary which was the problem with the glass containers for holding CA I used before discovering the bottle cap.

In addition to no cleaning, another benefit of the bottle cap is that it is reusable. Think of the bottle cap as having four posi-

tions: north, south, east, and west. You use one of the four bottle cap positions for the bottom. When CA hardens, you then turn the bottle cap so another position becomes the bottom to hold the fresh drops of CA. After the four positions are used up the bottle cap is moved to the trash and replaced by another.

And more benefits, the bottle cap has other uses beyond a CA holder. One example is a container for mixing paint; however, additional bottle cap uses are beyond the scope of this article.

The bottle cap is an almost free modeling tool. You can have it too. A simple, easy to obtain, cheap, disposable CA holding container for modeling – a bottle cap.



## TCD Timetable

**THURSDAY, April 10, 2008 6:45 pm**  
MODELING CLINIC (both sessions)  
Dave Hamilton - Sound for your trains  
POPULAR VOTE MODELING CONTEST  
Whimsical Railroads / NMRA Merit Point  
Judging

**THURSDAY, May 8, 2008 6:45 pm**  
**ANNUAL BUSINESS MEETING**  
**NOTE: The Annual Business Meeting will be held at the Jackson Street Roundhouse and the Popular Vote Modeling Contest on Buildings and Dioramas has been cancelled.**

**For updates, visit our NEW website at: [www.tcdnmra.org](http://www.tcdnmra.org)**

Continued from page 5  
**Jim Perske**

became a Minnesota Nonprofit Corporation. Jim was the first Secretary of the TCD. He helped organize, set the vision and the standard for the new division. During his first year as an officer the TCD was the local sponsor of the 1982 MRIA show. Jim continued to serve as TCD Vice-President in 1983-1984.

After Jim joined the Thousand Lakes Region he became an active volunteer recruiting new members. He served on the TLR Board Of Directors as Secretary for 1983 – 1984 and Treasurer for 1985-1986. While serving the TLR Jim

received the President's Award in 1988, the Bob Dew Senior Memorial Service Award in 1994, as well as being recognized with the "Bent Spike" award in the same year.

He joined with others to build a modular layout that could run long trains. Jim would often let children run the train. With a sparkle in his eye he would introduce a child to the joys he remembered from his youth. That simple action eventually resulted in a "Junior Engineer Certificate" that he would fill out with their name and give to them after running the train around the layout.

Jim was compassionate about his hobby

and about people. He hated conflict. He was always one to find the best in others and see both sides of an issue. His skills helped us all while he was an active member of the Thousand Lakes Region and Twin Cities Division.

Jim is survived by his wife Audrey; children Jay (Cindy) Perske and Jeanae (James) Justen; grandchildren, Nickolas, Nastassia, Josiah, Elijah, Zackary, Jacob and Jessa; brother Gerald (Elsie) Perske and a large extended family.

His contributions of time and energy were enormous. Jim will be missed; but not forgotten.

# Spring Layout Tour 2008

Saturday April 19, 2008, 1pm to 5pm

**Remember, we are guests in peoples' homes, so follow the rules for attending layout tours:**

1. You must be an NMRA member (bring your membership card) or be the guest (1 adult or >1 child okay) of an NMRA member.
2. Please do **NOT** touch.
3. Please do **not** arrive before 1 pm and leave by 5 pm.
4. Please sign the guest book
5. Leave coats outside the layout room to save the scenery.
6. No smoking.

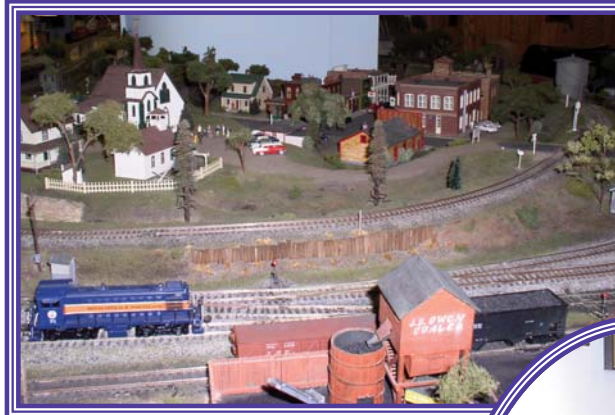

**Les Breuer, MMR**  
5605 Grand Ave S  
Minneapolis, MN

**Minneapolis & Northland Railroad**  
This railroad captures central Minnesota from McGregor to Minneapolis. You will see the railroad travel through the rolling hills or central Minnesota on its two hour journey. This track plan is a adaptation of a continuous twice-around with yards and an alternate route

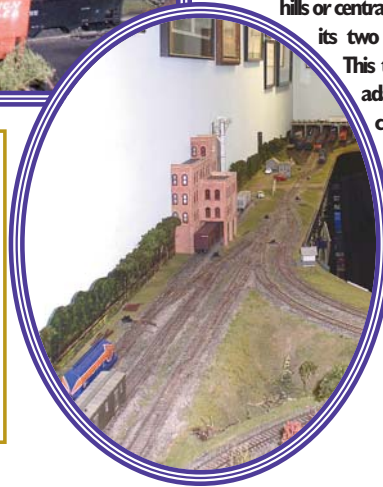

**Martin Hrabec**  
6326 Clinton Ave S  
Richfield, MN

Our CLASS I railroad, built by a great group of guys, is a free-lanced 24' x 32' multi-leveled layout. The main-line a point to point with reverse loops at each end for continuous running during open houses. It is a single track mainline with several small towns along the way with passing sidings.

There are two main junctions that interchange. One junction interchanges the Rock Island, Great Northern, and the Milwaukee Road. The other Junction interchanges the Rock Island with the Soo Line, and the NP.

About 60% of the layout is scenicked with mountains, coal, ore, lumber and several other industries. This is one layout you really do not want to miss. If you were here at the Christmas open house, you will be amazed what we have done since then.



**John Hotvet, MMR**  
5100 Nicollet Ave So  
Minneapolis MN

Prototype AT&SF and D&RGW  
This RR is set in Colorado during the early 50's. The setting is eastern Colorado where the landform transitions from prairie to mountain. Most trains are powered by Santa Fe power, but the Denver & Rio Grande joint trackage along the front range of the Rockies, this joint trackage penetrates into the heart of the Rocky Mountains and has to contend with major mountain grades.

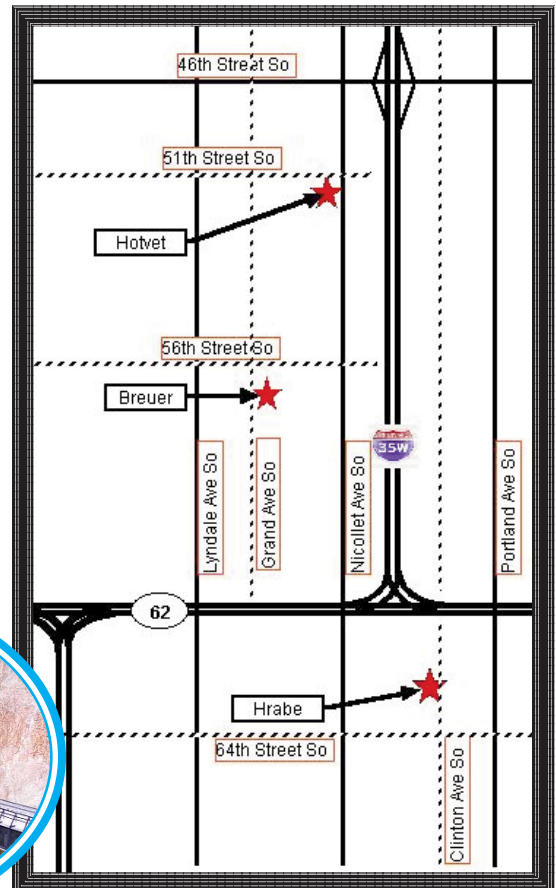
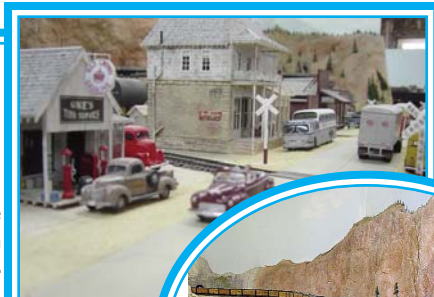

# Railfan & Hobby Show CALL BOARD

COMPILED BY JIM BERNIER

## Saturday, 04/05

### Greater Upper Midwest Train Show

Location: Century College, 3300 Century Ave N, White Bear Lake, MN, Admission: \$4.00, 9 AM - 2 PM  
For more info - Tom Jefferson 651-429-2885

## Sat/Sun, 04/12-13

### Happy Grandparents Model Train Show

Location: Menomonie Middle School, 920 21st St South, Menomonie, WI  
Admission: Adults \$5.00, Students \$3.00, Families \$12.00, Children under 6 with parent - FREE, Food Donation - .50 discount, Sat - 9:00 AM - 5:00 PM, Sun - 10:00 AM - 4:00 PM  
For more info - 715-879-4185 or 715-505-4440 (after 7:00 PM)

## Sat, 04/12

### Luce Line Model Railroad Club Spring Mail Show

Location: Hutchinson Mall, Hutchinson, MN  
Admission: FREE, 10 AM - 6 PM,  
Sellers Table info - mkbraun@hutchtel.net  
Layout Display info - zachmeyer@mac.net

## Saturday, 04/19

### Newport Club - Woodbury Flea Market

Location: Woodbury Senior High School, Woodbury, MN  
Admission: \$5.00, 10:00 AM - 3:00 PM  
For More Info: Stan Whitingham 952-200-9729

## Saturday, 04/26

### Tri-State Rails 2008 - PLD Spring Meet

Location: Old Milwaukee Road Shops (Roundhouse) 3400 Sioux River Road, Sioux City, IA  
9:00 AM - 4:00 PM, Admission: \$3.00 General \$2.00 PLD Members, For More Info: Jim Van Delden 402-833-5531, Ron Peterson 712-225-4780

## Sat/Sun, 04/26-27

### Titletown Train Show

Location: Shopko Hall, 1901 South Oneida St. Green Bay, WI, Sat 9 AM-5 PM / Sun 10 AM - 4 PM  
For More Info: 920-217-5318, info@ttsqbllc.com

## Thur-Sun, 05/01-04

### Twin Ports Express/NMRA-TLR Convention

Location: Depot Museum, Duluth, MN  
For More Info: cjdancy@msn.com or go to the TLR web site: <http://www.thousandlakesregion.org/pages/conventions.html>

## Saturday, 05/03

### Granite City Train Show

Location: National Guard Armory, 1710 Veterans Drive, St Cloud, MN, 9:00 AM - 2:30 PM, Admission: \$3.00 (under 12 FREE), For More Info: 320-255-0033, edwardolson@doudnet.com or [www.granitecitytrainshow.com](http://www.granitecitytrainshow.com)

## Saturday, 05/19

### TCMRRM Train & Railroadiana Sale

Location: Minnesota State Fairgrounds, Education Building, 9:00 AM - 3:00 PM, Admission: \$5.00 (under 5 FREE) For More Info: 651-647-9628

## Sun-Sat, 07/13-19

### Anaheim Special - NMRA National Convention

Location: Anaheim Marriot, Anaheim, CA  
For More Info: <http://www.nmra.org/2008/>

## Sat, 07/21

### St. Cloud Area Railroad Legacy Project

Location: Waite Park City Hall, Waite Park, MN. 1:00 PM, Admission: Free.  
No contact information at this time.

## PROPOSED BYLAWS CHANGE

by David Hohle, TCD Secretary

As published in the previous Crossing Gate, a proposed change is recommended that eliminates of the Contest Director as a position on the Board of Directors. This change would reduce the board to seven members, an odd number, thus making tie votes less likely. The position is an appointed seat by the President and has remained unfilled for a number of years.

In light of recent communications with Bob Amsler, NMRA General Counsel, the Board of Directors also voted to have an open discussion by the membership of what ought to constitute being a TCD member at the annual meeting. Dialogue among members, within the TCD Board, and in the last Crossing Gate have dealt with the NMRA requirement that membership in a region or a division occurs solely as a result of being an NMRA member. The NMRA has further stipulated that an individual can only be a guest for a limited period, after which the person needs to decide whether or not to become a member by joining the NMRA. The TCD Board has taken a position not to propose additional bylaw changes regarding this issue at this time, but rather hold an open forum to learn what to do from those who participate in the TCD.

A letter has been sent to the Thousand Lakes Region's Board of Directors concerning communication from NMRA and requesting direction from the TLR regarding the membership issue.

**[Editor's Note: To review the existing TCD Bylaws, go to our web site at [www.tcdnmra.org](http://www.tcdnmra.org)] or call a member of the board for a copy.**

Comments from Bob Amsler, NMRA's legal counsel, state that the TCD needs to amend its bylaws to be in compliance with the NMRA regulations. The greatest need for change occurs in Article I, Section A where Mr. Amsler states that the TCD is at variance with the NMRA regulations. Definitions of the terms "member" and "subscriber" need to be more precise. He also states that the term "dues" is used inappropriately. Finally, Mr. Amsler reiterates that divisions are subdivisions of regions and that the regions are subdivisions of the NMRA, and that like the U.S. Constitution, the supremacy clause (Article VII) prevents TCD non-compliance by stating that no act of the corporation [TCD] nor portion of [its] Bylaws shall conflict with the Constitution, Bylaws, or other regulations of the TLR or the NMRA.

## Subscribe or renew NOW!

Send \$10 per year (two year max) to:

Twin Cities Division,  
4476 Mason Ave NE

St. Michael, MN 55376

Enclosed is \$ \_\_\_\_\_ for \_\_\_\_\_ year(s)

Member (must be NMRA member) [  ]

Subscriber (Crossing Gate only) [  ]

New [  ]

Renewing [  ]

I want my Crossing Gate delivered by:

US Mail (paper, black/white) [  ]

Electronic mailing (email, color) [  ]

Name: \_\_\_\_\_

Address: \_\_\_\_\_

City/State/Zip \_\_\_\_\_

Email: \_\_\_\_\_

Home phone: (\_\_\_\_\_) \_\_\_\_\_

Preferred Modeling Gauge(s) \_\_\_\_\_

Preferred Prototype Railroad(s) \_\_\_\_\_

NMRA member number (required for member status) \_\_\_\_\_



## TRAIN RIDES

Osceola, WI  
or  
Jackson Street  
Roundhouse,  
St. Paul

Present this coupon for

**\$2 off any Adult Fare at  
Osceola**

or

**\$1 off any Roundhouse Ticket**

Valid

**Osceola, WI:**

**May - October 2008**

**Roundhouse: Year 'round on  
regular schedules only**

**(715) 755-3570**

**[www.trainride.org](http://www.trainride.org)**

**TCD08**

**Expires May 1, 2009**

## THE CROSSING GATE

Twin Cities Division, TLR, NMRA  
4476 Mason Ave NE  
St. Michael, MN 55376

### Next meeting:

April 10, 2008 at 5:45 for dinner  
at 6:45 pm for clinic only

### Where:

Mill City Museum  
704 South Second Street  
Minneapolis, MN 55401  
612-341-7555  
[millcitymuseum.org](http://millcitymuseum.org)

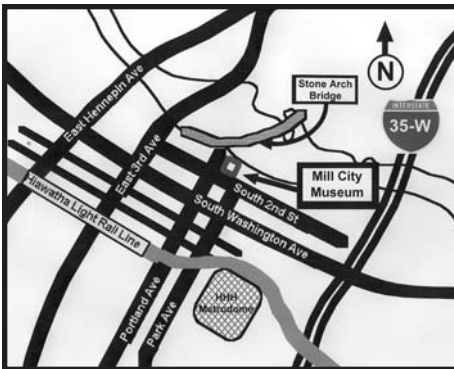

## Local Twin Cities Hobby Shop Sponsors

*These listings are sponsors of the Twin Cities Division. Please show them your support!*

### **Becker's Model Railroad Supply**

2166 Silver Lake Road  
New Brighton, MN 55112  
(651) 635-9480  
<http://members.aol.com/wcbecker>

### **Choo Choo Bob's**

2050 Marshall Avenue  
Saint Paul, MN 55104  
(651) 646-5252

### **Historic Rail**

121 5th Ave NW  
New Brighton, MN 55112  
(651) 635-0100  
<http://www.historicrail.com>

### **Hobbytown USA**

1750 Weir Drive  
Woodbury, MN 55125  
(651) 702-0355  
[http://www.hobbytown.com/zcl/detail.html?zcl\\_info\\_id=73](http://www.hobbytown.com/zcl/detail.html?zcl_info_id=73)

### **Hub Hobby Center**

82 Minnesota Ave.  
Little Canada, MN 55117  
(651) 490-1675  
<http://hubhobbycenter.com>

### **Hub Hobby Center**

6416 Penn Avenue S  
Richfield, MN 55423  
(612) 866-9575  
<http://hubhobby.com>

### **KDC Model Trains**

915 Hopkins Ctr.  
Hopkins, MN 55343  
(952) 938 - 5456  
<http://www.KDC-Trains.com>

### **Osceola & St. Croix Valley Railway**

P.O. Box 176  
114 Depot RD  
Osceola, WI 54020  
715-755-3570  
<http://www.trainride.org>

### **Osseo Train World**

340 Central Avenue  
Osseo, MN 55369  
(763) 425-7171

### **Prairie Works Productions**

6300 Sequoia Circle  
Eden Prairie, MN 55346  
<http://www.prairie-works.com>

### **Scale Model Supplies**

458 Lexington Parkway  
Saint Paul, MN 55104  
(651) 646-7781  
<http://www.scalemodelsupplies.com>